

## GLISS WALK-IN — MDT 2013

1—  
12



Gliss Walk-In is a complete system of walk-in wardrobes. The wardrobe isolates itself to become a real self-standing room. Gliss Walk-In lends itself to linear and angular solutions, suitable for all types of space, thanks to a “tailored” design system, available in many different finishings. All the equipment, which mirrors that of the Gliss Wardrobes, can be arranged freely in height, both suspended and on the floor, thanks to a system of painted invisible self-blocking rods.

FINISHES

finishes

	natural anodised	black anodised	melamine	matt lacquer colours	woods	coloured glass/ etched coloured glass	mirror	black chrome
components								
wall profile								
lateral finishing profile								
back panels								
base								
plinth on base								
shelves								
clothes rails								
structure of trays/drawer units								
fronts of wood drawer units								
drawer units finishing tops								

colours

<b>Matt lacquer</b> BC chalk white PE pearl DN dune PL platinum NE black AT anthracite SE mustard SI silica DO dolomite grey AL clay MK moka CM caramel CZ light blue grey SA sand RU ruby RE rust PX pewter colour RX copper TO dove grey	<b>Woods</b> EU eucalyptus RG grey oak RF graphite oak	<b>Coloured glass</b> BC chalk white PE pearl DN dune PL platinum NE black AT anthracite SE mustard SI silica DO dolomite grey AL clay MK moka CM caramel CZ light blue grey SA sand RU ruby RE rust PX pewter colour RX copper TO dove grey	<b>Etched coloured glass</b> BC chalk white PE pearl DN dune PL platinum NE black AT anthracite SE mustard SI silica DO dolomite grey AL clay MK moka CM caramel CZ light blue grey SA sand RU ruby RE rust PX pewter colour RX copper TO dove grey	<b>Melamine</b> YM larix dark YA silver cembran
---	---	---	--	---

## TECHNICAL INFORMATION

### WALL PROFILE

Extruded anodised aluminium.

### MELAMINE FACED SHELF/BASE

Wooden particleboard panel faced with melamine. Metal brackets to fasten the shelf to the wall profile. Adjustable feet for the base.

### LACQUERED SHELF/BASE

Wooden particleboard panel faced with melamine, painted in the colours of the “Molteni Range”. Metal brackets to fasten the shelf to the wall profile. Adjustable feet for the base.

### WOOD SHELF/BASE

Wooden particleboard panel faced with wood veneer in Oak (*Quercus*) or Eucalyptus (*Eucalyptus globulus*). Metal brackets to fasten the shelf to the wall profile. Adjustable feet for the base.

### BACK PANEL, DRAWER UNIT STRUCTURE, DRAWER AND TRAY FRONTS, DRAWER SIDES AND BOTTOM (MELAMINE FACED)

Wooden particleboard panel faced with melamine.

### BACK PANEL, DRAWER UNIT STRUCTURE, DRAWER AND TRAY FRONTS (LACQUER)

Wooden particleboard panel faced with melamine, painted in the colours of the “Molteni Range”.

### BACK PANEL (GLASS VERSIONS)

Wooden particleboard panel faced with melamine, with applied mirror or tempered glass (th. 5 mm), transparent or etched, painted in the colours of the “Molteni Range”.

### GLASS DRAWER FRONT

Wooden particleboard panel faced with melamine or painted in the colours of the “Molteni Range”. Tempered glass th. 4 mm.

### CLOTHES RAILS

Tube in chrome plated steel. Tube support in chromed plastic.

### LATERAL FINISHING PROFILE

Medium density fibre panels faced with melamine paper, painted in the colours of the “Molteni Range”.

### SHOE RACK ROD OR TROUSER ROD

In anodised extruded aluminium with plastic insert.

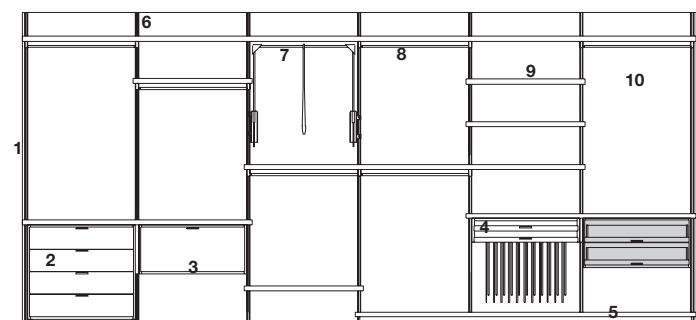

- 1 LATERAL FINISHING PROFILE
- 2 FRONT OF WOOD DRAWER
- 3 STRUCTURE OF DRAWER UNIT
- 4 TRAYS
- 5 BASE
- 6 WALL PROFILE
- 7 SERVETTO PULL-OUT CLOTH RAIL
- 8 CLOTH RAIL
- 9 SHELF
- 10 BACK PANEL

### DRAWER INTERIOR

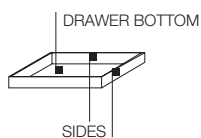

MODULARITY

Methods of executing custom cuttings

- In height:
- all vertical profiles (wall-mounted, spacers, finishing profiles) can be reduced to the desired size
  - the height of the back panels is custom cut
- In width:
- custom reduction up to -614 mm (24 1/8") is available only on 1 module
  - the minimum possible width for a module is 328 mm

- In depth:
- custom depth measurements can be done only on bases and non-jointed shelves.
  - the minimum measurement that can be done is 350 mm.

- the size of trays and modular drawer units cannot be reduced
- hanging structures can be fastened only to standard compartments with W 942 (37 1/8")
- if a wider shelf is placed on top of any drawer unit (either freestanding, suspended or resting on the base), the drawer unit must be of standard width 942 (37 1/8").
- two drawer units are available for compartments cut to measure (suspended, standing on base or floor standing).

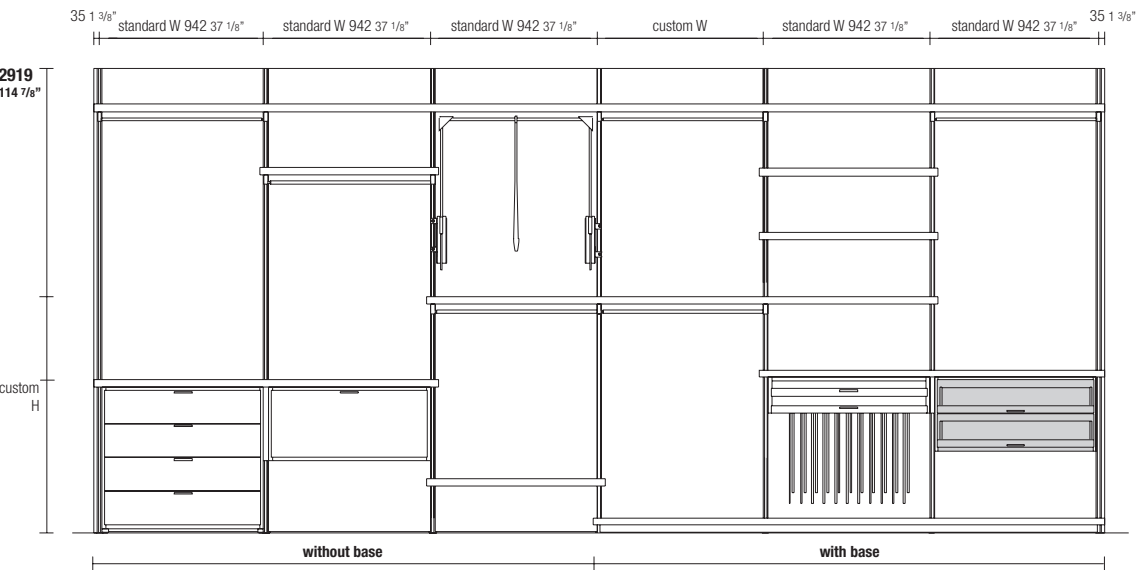

module with or without back panel

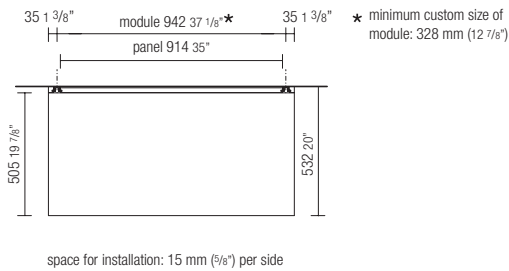

corner element with or without back panel

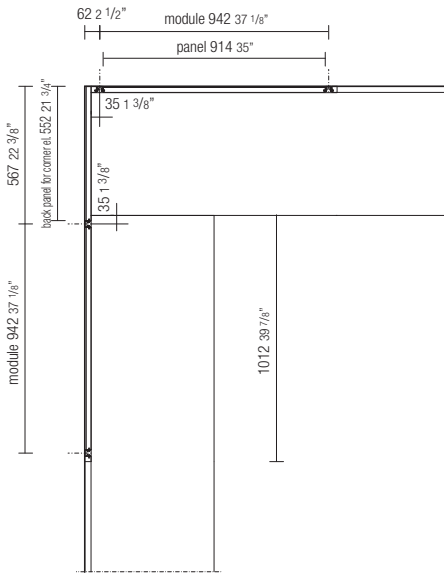

MODULARITY

Linear composition with or without back panels

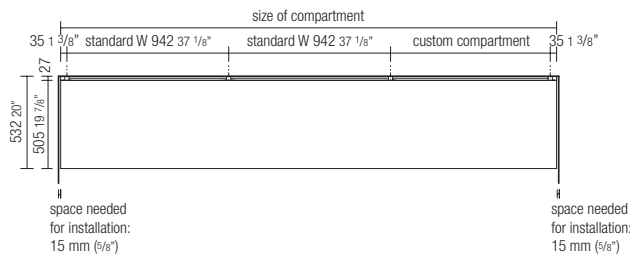

Corner composition with or without back panels

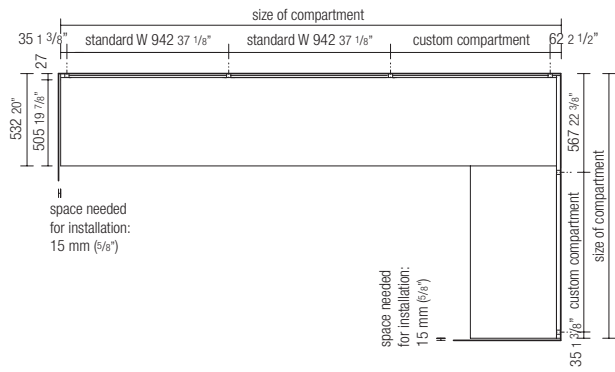

C-shaped corner composition with or without back panels

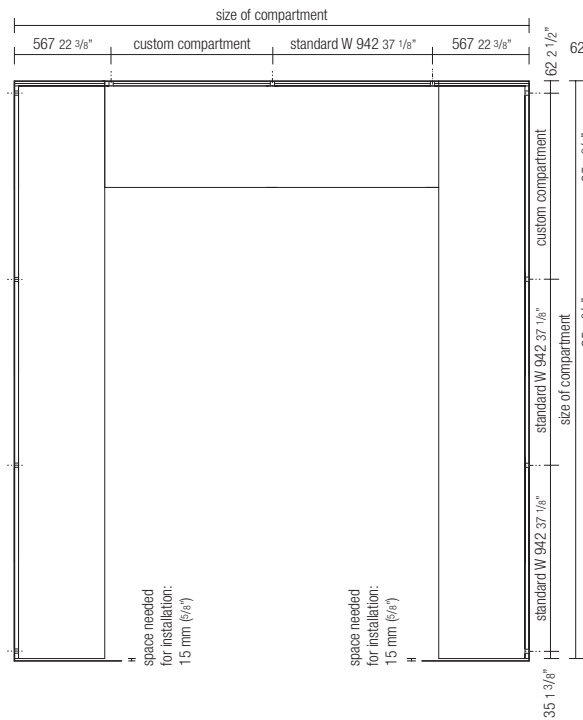

C-shaped corner composition without back panels on corners

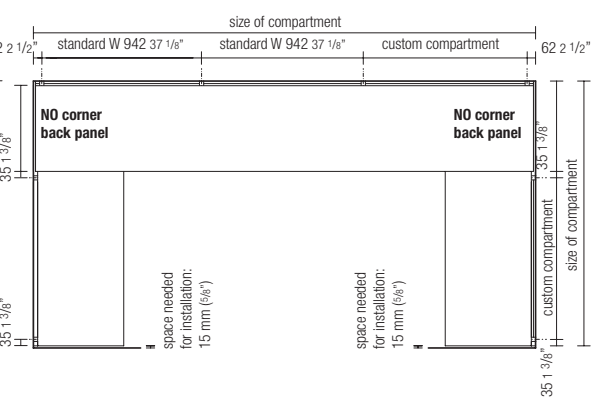

## NOTES

- hanging structures with H 110 can contain any tray
- hanging structures with H 206 can contain trays and also a pull-out tray or a H 190 drawer
- drawers, pull-out trays and trinket trays can be freely installed on all other structures, according to the height of the module
- the interiors of the drawers have always a grey saffiano melamine finish
- in case there is no shelf placed over the drawer unit, a 10 mm thick finishing top is always needed
- no shelves can be positioned in the modules adjacent to a drawer unit.

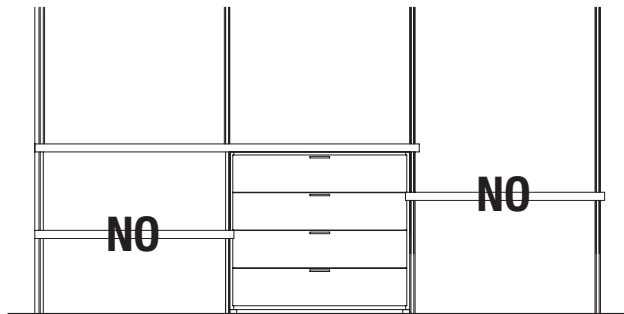

### Handle in pewter colour finish

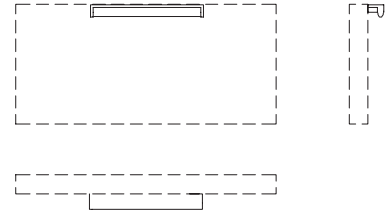

### Notes

Prices of drawers, trays and pull-out trays include the cost of the pewter colour finish handle. For the handle covered in Eco Skin, add a supplementary charge.

### Reductions

- **the size of trays and drawer units cannot be reduced**
- hanging structures can be fastened only to standard compartments with W 942
- if a shelf is placed on top of a drawer unit (either free-standing or resting on the base) the drawer unit must occupy a standard W 942 module.

### Drawer units for width custom compartments

To enhance the functional features and adaptability of Gliss Walk-In to all situations, two drawer units H 417/439 with reduced width are available (W 614 for modules cut to measure up to W 642, and W 450 for modules cut to measure up to W 478). These drawer units can be used suspended above the shelf, either supported by the base or floor standing.

### Notes

Besides the instructions concerning the drawer units 942 W, we add following:

- Drawer units always have two wooden drawers H 190
- The suspended drawer unit can be positioned either on the left or right part of the reduced module.

### example of drawer unit suspended on the left

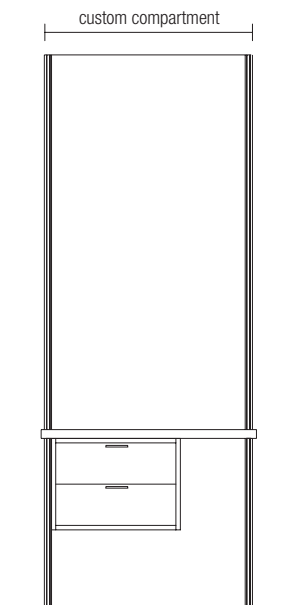

FITTINGS

**Base**  
**D 505 th 83 3 1/4"**  
**with adjustable feet**

**W 1012 39 7/8"**  
(1 module)

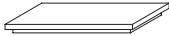

BA5/10

**W 1954 76 7/8"**  
(2 modules)



BA5/20

**W 2896 114"**  
(3 modules)



BA5/29

**Shelf**  
**D 505 th 40 1 5/8"**  
**with mounting brackets**

**W 1012 39 7/8"**  
(1 module)  
2 brackets

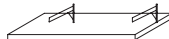

RI5/10

**W 1954 76 7/8"**  
(2 modules)  
3 brackets

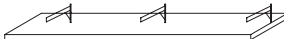

RI5/20

**W 2896 114"**  
(3 modules)  
4 brackets

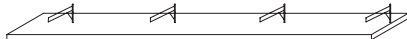

RI5/29

**Jointed shelf**  
**D 505 th 40 1 5/8"**  
**with mounting brackets**

**W from 2897 to 3838**  
**W from 114" to 151 1/8"**  
(4 modules)  
5 brackets



RG5/38

**W from 3839 to 4780**  
**W from 151 1/8" to 188 1/4"**  
(5 modules)  
6 brackets

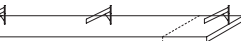

RG5/48

**W from 4781 to 5722**  
**W from 188 1/4" to 225 1/4"**  
(6 modules)  
7 brackets



RG5/57

**cloth rails**  
**module W 942 37 1/8"**



P094

**servetto pull-out cloth rail**  
can be used on W 942 (37 1/8") to  
W 670 mm (26 3/8") modules

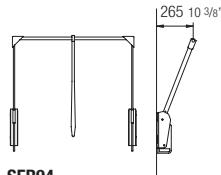

SER94

**pull-out coat hanger**



AGR1

FITTINGS

**pull-out tray**  
**W 884 D 468**  
**W 34 3/4" D 18 3/8"**  
H 57 2 1/4" (front)

**trays**  
**W 884 D 468**  
**W 34 3/4" D 18 3/8"**

**trouser holder tray**  
H 57 2 1/4"  
n. **12** bars max

**trinket tray**  
**(ties and belts)**  
H 57 2 1/4"

**additional trouser holder bar**  
(grey saffiano embossed finish)

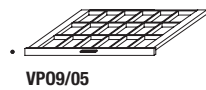
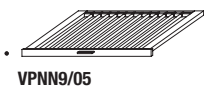
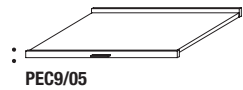

**drawers**  
**W 884 D 468 H 190**  
**W 34 3/4" D 18 3/8" H 7 1/2"**  
usable spaces  
W 834 D 435 H 106

**wooden drawer**

**glass drawer**  
in transparent glass serigraphed in  
Molteni colour range

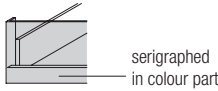
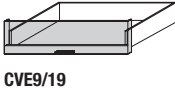
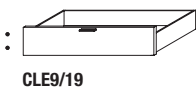

**drawers**  
**W 884 D 468 H 382**  
**W 34 3/4" D 18 3/8" H 15"**  
usable spaces  
W 834 D 435 H 298

**wooden drawer**

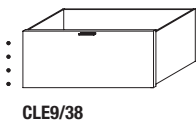

FITTINGS

Internal fittings - accessories for drawers

**Leather trays**  
Handmade leather trays with Alcantara bottom.  
The version for men is brown (cat. P col. D533),  
The version for women is powder pink (cat. P col. D524).

**Eco Skin bottoms**  
Made with grey coloured Eco Skin.

**leather trays**  
**men's drawers**  
W 206 D 430 H 58 (A)  
W 206 D 215 H 58 (B)

watch holder  
(A)

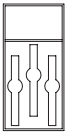

CEV/MA1

watch/  
bracelet holder  
(A)

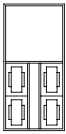

CEV/MA2

jewellery holder  
with movable dividers  
(B)

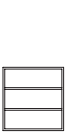

CEV/MB1

complete men's  
drawer offer

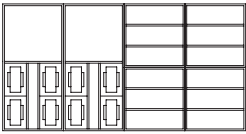

CVM1

brown leather

**leather trays**  
**women's drawers**  
W 206 D 430 H 58 (A)  
W 206 D 215 H 58 (B)

watch holder  
(A)

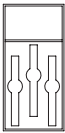

CEV/WA1

watch/  
bracelet holder  
(A)

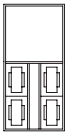

CEV/WA2

jewellery holder  
with movable  
dividers  
(B)



CEV/WB1

ring holder  
(B)



CEV/WB2

earring holder  
(B)

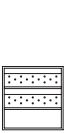

CEV/WB3

complete women's  
drawer offer

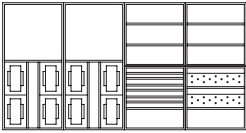

CVW1

powder pink leather

**Modularity drawings  
for inserting trays into  
drawers**

drawer W 416

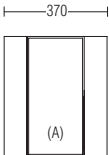

1 tray (A)  
or 2 trays (B)

drawer W 580

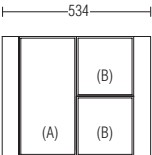

2 trays (A)  
or 4 trays (B)

drawer W 880

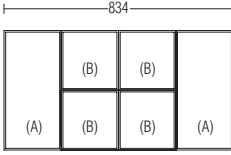

4 trays (A)  
or 8 trays (B)

**Eco Skin bottoms  
for drawers**  
D 432



W 366

CEQ/F4

W 530

CEQ/F6

W 830

CEQ/F9

grey Eco Skin

FITTINGS

Led lighting

Shelves can be accessorised with LED lighting.  
Lighting systems are conformant with European safety standards.

**Notes**  
At the moment of the order, the customer must always indicate on the drawing the shelf or the shelves where the lighting bars should be installed. The bars will always follow the width of the shelf. If the shelf is jointed, two bars will be made, one for each part of the shelf.

10 —  
12

**lighting bars  
for shelves  
3000 K**

consider two singles  
bars for jointed  
shelves

**for shelves  
up to W 1012 - 39 7/8"**



watt 12  
**EB110**

**for shelves  
up to W 1954 - 76 7/8"**



watt 22  
**EB120**

**for shelves  
up to W 2896 - 114"**



watt 33  
**EB129**

**components  
per system**  
(see the diagram for  
component use and to  
calculate system cost)

**power supply unit  
100W**

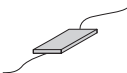

**EAL1**

**connector**



**EC01**

**radio control kit  
with brightness  
setting  
(1 per power  
supply unit)  
optional**



**EKRR1**

**DALI kit  
(for DOMOTICA)**  
n. 1 for each  
power supply unit  
cannot be used with  
radio remote control



**EKDA1**

**types of systems with remote control**  
**electrical socket or radio remote control**  
one radio remote control unit can control  
systems with 2 power supply units max.  
Otherwise, more radio remote control units must  
be used.

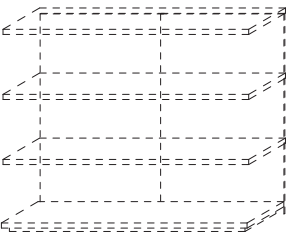

★ each power supply unit can power a max. of 100W or:  
max 6 LED lights

power supply unit (per composition ★)	●
connector (for compositions of 4 power supply units max.)	●
radio remote control (optional)	● (optional)

SAMPLE COMPOSITIONS

composition 1

backs: melamine  
shelves: melamine  
fittings: melamine

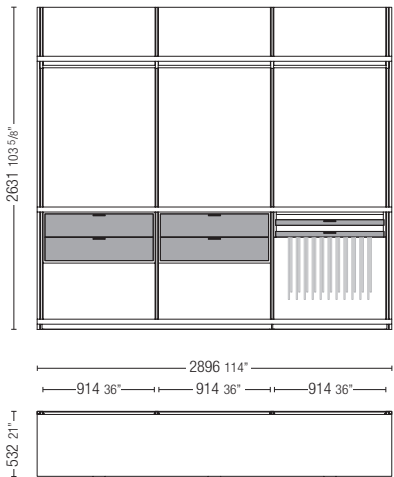

GCC01

composition 2

backs: melamine  
shelves: melamine  
fittings: melamine

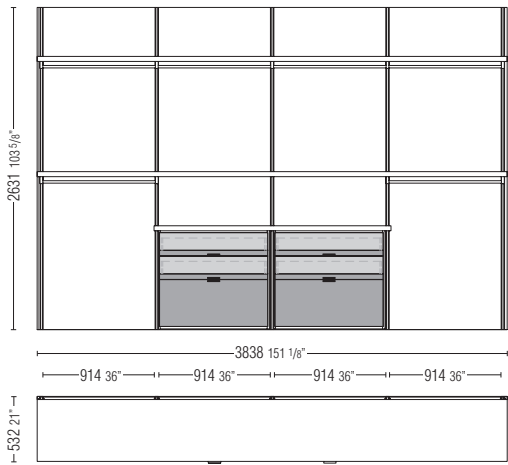

GCC02

SAMPLE COMPOSITIONS

composition 3

backs: melamine  
shelves: melamine  
fittings: melamine

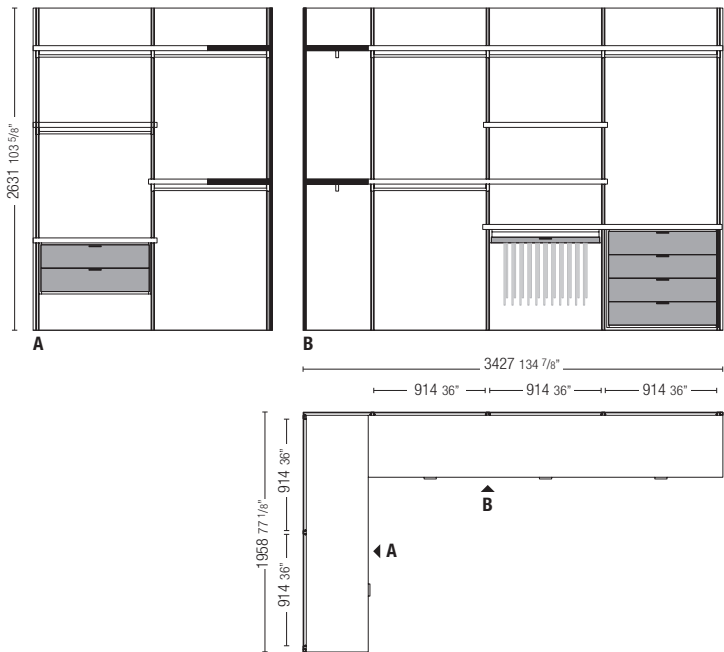

GCC03

composition 4

backs: melamine  
shelves: melamine  
fittings: melamine

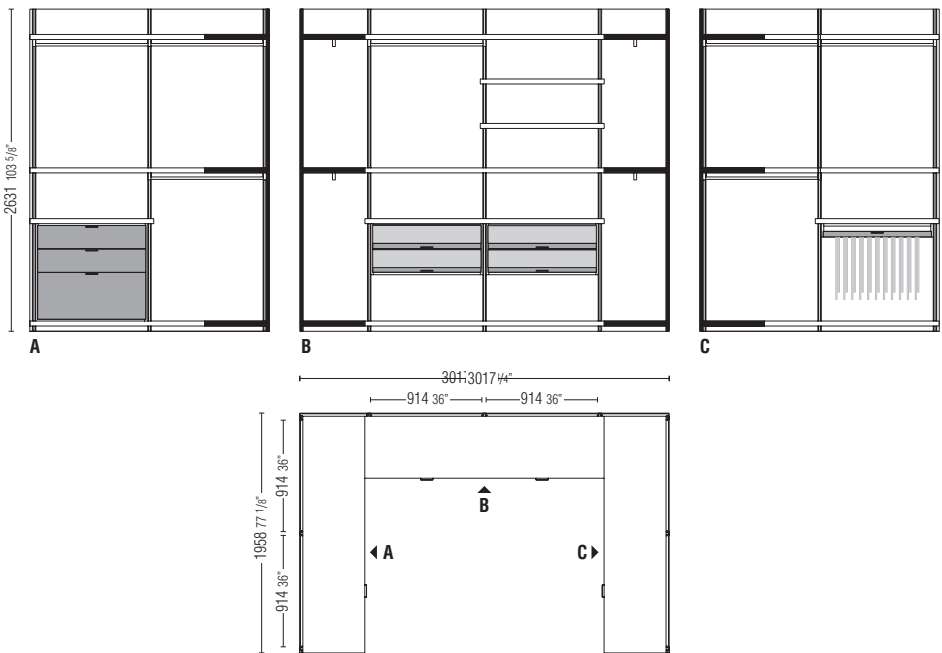

GCC04

# Molteni & C

## FINISHES MOLteni&C RANGE

IX.2018

	MATT LACQUER	GLOSSY LACQUER	COLOURED GLASS	ETCHED COLOURED GLASS	CARTAPAGLIA LACQUERED only Gliss Master	STOPSOL GLASS TRANSPARENT STOPSOL GLASS
CHALK WHITE	•	•	•	•	•	
PEARL	•	•	•	•	•	
SILICA	•	•	•	•	•	
SAND	•	•	•	•	•	
DOVE GREY	•	•	•	•	•	
PLATINUM	•	•	•	•	•	
DUNE	•	•	•	•	•	
CLAY	•	•	•	•	•	
DOLOMITE GREY	•	•	•	•	•	
COPPER	•	•	•	•	•	
RUST	•	•	•	•	•	
RUBY	•	•	•	•	•	
CARAMEL	•	•	•	•	•	
MOKA	•	•	•	•	•	
MUSTARD	•	•	•	•	•	
LIGHT BLUE GREY	•	•	•	•	•	
PEWTER COLOUR	•	•	•	•	•	
ANTHRACITE	•	•	•	•	•	
BLACK	•	•	•	•	•	
STOPSOL						•
LESSLESS RED	•					
only matt lacquer						

# Molteni & C

## FINISHES MOLTENI&C RANGE

IX.2018

### WOODS

EUCALYPTUS

AMERICAN WALNUT

GRAPHITE OAK

GREY OAK

BLACK OAK

WALNUT

CEDAR

ASH WOOD IN NATURAL COLOUR

ASH WOOD STAINED BLACK

### MARBLES

WHITE CARRARA

RED LAGUNA

EMPERADOR DARK

BLACK MARQUINA

ORIENT GREY

SAHARA NOIR

CALACATTA GOLD

### METAL PARTS

BLACK CHROME

SHINY ALUMINIUM

PEWTER COLOUR

COPPER

BRONZE

DWELL  
DOOR FRAME, TRACK COVERING PROFILES

ANODISED ALUMINIUM

BROWN ALUMINIUM

The finishes shown are indicative and refer to the entire production range. We recommend that you consult the "Colour Range" samples which shown the complete range of finishes, including those not shown here. Molteni&C reserves the right to modify the range without warning.

# Molteni & C

## FINISHES MOLTENI&C RANGE

IX.2018

MELAMINE FRONT  
GLISS MASTER

CARTAPAGLIA WHITE



CARTAPAGLIA ANTHRACITE



CARTAPAGLIA SILICA



GRAFFIATO SILICA



GRAFFIATO BRONZE



SILK DOVE GREY



SILK SILICA



SILK CHALK WHITE



MELAMINE STRUCTURE  
GLISS MASTER

WHITE SHANTUNG

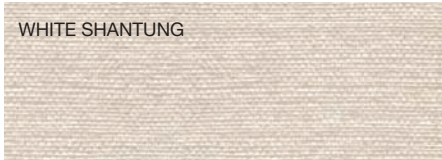

GREY SHANTUNG



MELAMINE STRUCTURE  
GLISS MASTER, MASTER DRESSING,  
GLISS WALK-IN

SILVER CEMBRAN



LARIX DARK

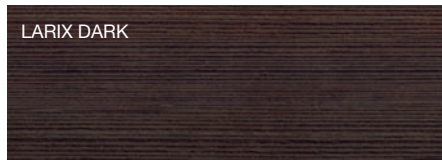

MELAMINE STRUCTURE  
GLISS MASTER, MASTER DRESSING

WHITE



ECO SKIN

IVORY



HEMP



MINK



DARK BROWN

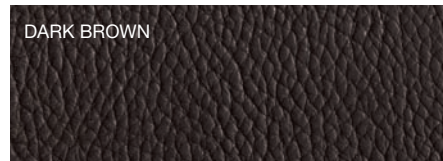

GREY



FINE GRAIN

FINE GRAIN

