

GRID — VINCENT VAN DUYSSEN 2018

1—
19



Grid is a new research chapter in what are known today as modular wall-systems. Research into the evolution of domestic space, also thanks to the presence of electronic devices that extend the perception of space. Grid is a modular system characterized by a wall-anchored folding panel system, inside which, on request, LED lighting can be installed, both in the central part and at the top, all the way down, along with various connections linked to sounds and images and hi-tech equipment. The aim is to achieve a flexible open system based on a modular grid, which organizes the component parts and exalts their function. As in a crossword, hooked to the boiserie, the wall at the bottom part can be accessorized with containers, either hanging or on the floor and fitted with thick shelves or with trays lined at the bottom with Ecoskin. Grid's compositional freedom is further extended at the top by open bookshelves, display units of varying heights, with either Pewter or Copper metallic finishes, for precious ornaments, pictures or mementos. The compositional system is open-ended and can be expanded by using different finishes, to be mixed and matched at will.

FINISHES

finishes	matt lacquer colours	woods	glossy lacquer colours	transparent stopsol glass	pewter colour / copper / zinc	Eco Skin	bonded hide leather	bronze mirror
components								
WALL PANELLING								
panel								
SUPPORT SHELF								
shelf								
TRAY								
shelf								
accessory bottom								
CONTAINER UNDER SUPPORT SHELF OR TRAY								
structure / internal partition								
flap door / drawer front								
BOOKCASE								
shelf								
back								
partitions								
GLASS CABINETS								
wooden back / side								
glass side / hinged door	profile							
	glass							
shelves / base / lid								
SHOWCASE								
structure / support								
CHARGING ACCESSORY								
structure								

colours	Matt lacquer	Glossy lacquer	Woods
	BC chalk white	BC chalk white	EU eucalyptus
	PE pearl	PE pearl	NO walnut
	DN dune	DN dune	RF graphite oak
	PL platinum	PL platinum	
	NE black	NE black	
	AT anthracite	AT anthracite	
	SE mustard	SE mustard	
	SI silica	SI silica	
	DO dolomite grey	DO dolomite grey	
	AL clay	AL clay	
	MK moka	MK moka	
	CM caramel	CM caramel	
	CZ light blue grey	CZ light blue grey	
	SA sand	SA sand	
	RU ruby	RU ruby	
	RE rust	RE rust	
	PX pewter colour	PX pewter colour	
	RX copper	RX copper	
	TO dove grey	TO dove grey	

TECHNICAL INFORMATION

WALL PANELLING

Wood particle board panelling covered with sliced veneer in Oak (*Quercus*), Eucalyptus (*Eucalyptus globulus*), Walnut (*Juglans Nigra*) or melamine finish, painted in the colors from the “Molteni Range”.

Wall mounting profile in extruded anodized aluminum.

Mirror version with chipboard panel with melamine facing on which the silvered bronze tempered crystal is positioned, thickness 5 mm.

GUIDE FOR ANCHORING SHELVES AND CENTRAL PROFILE

Extruded anodized aluminum.

SUPPORT SHELF

Wood particle board panel covered with sliced veneer in Oak, Eucalyptus, Walnut or melamine finish, painted in the colors from the “Molteni Range”.

Fastening elements in laser-cut and painted sheet metal.

Undertop track (optional) in extruded anodized aluminum.

TRAY

Wood particle board panel covered with sliced veneer in Oak, Eucalyptus, Walnut or melamine finish, painted in the colors from the “Molteni Range”.

HANGING OR FREE STANDING CONTAINERS

Wood particle board panel covered with sliced veneer in Oak, Eucalyptus, Walnut or melamine finish, painted in the colors from the “Molteni Range”.

Fastening elements for suspended containers in laser cut and painted sheet metal.

The floor storage units are equipped with adjustable support feet.

SIDES AND DRAWER BOTTOMS

Wood particle board paneling covered with melamine finish.

BOOKCASE

Wood particle board panel covered with sliced veneer in Oak, Eucalyptus, Walnut or melamine finish, painted in the colors from the “Molteni Range”.

Fastening elements in painted metal.

BOOKSHELVES PARTITION

Bent sheet metal covered with bonded hide leather.

SHOWCASE

Wood particle board paneling covered with melamine finish, painted in the colors from the “Molteni Range” or with applied silver bronze glass, thickness 4 mm. Perimeter profile in painted aluminum.

GLASS CABINET - WOODEN PARTS

Wood particle board panel covered with sliced veneer in Oak, Eucalyptus, Walnut or melamine finish, painted in the colors from the “Molteni Range”.

Fastening elements in painted metal.

GLASS CABINET - PARTS IN GLASS AND SHELVES

Extruded or painted aluminum. Tempered crystal, thickness 4 mm.

Shelves in painted bent sheet metal.

LIGHTING AND ELECTRICAL COMPONENTS

All components are compliant with regulations and certified as shown on the individual parts.

TECHNICAL INFORMATION

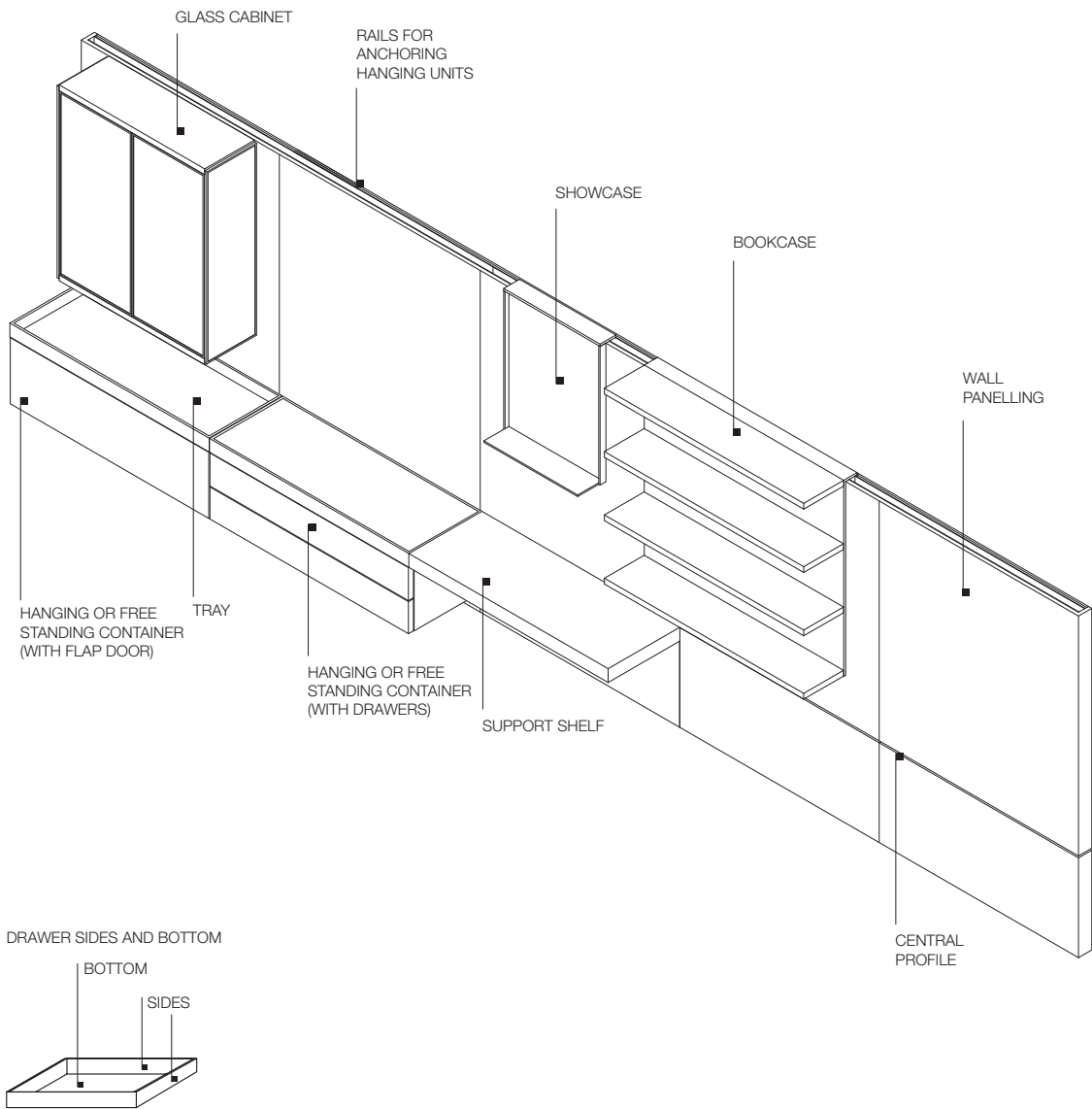

NOTES

- Corner compositions may be created by putting two straight compositions together.
- The support shelf may be made of a single piece up to 3000 mm.
- Hanging or standing containers must be positioned under the support shelf or must be equipped with a top tray.
- The composition may be lit in the central part, in the upper part, or both.
- The glass cabinet and the bookcase can be equipped with a lighting system that is independent from the one in the panelling.
- Consider a space of 15 mm in width to mount the panels.

Example of a composition

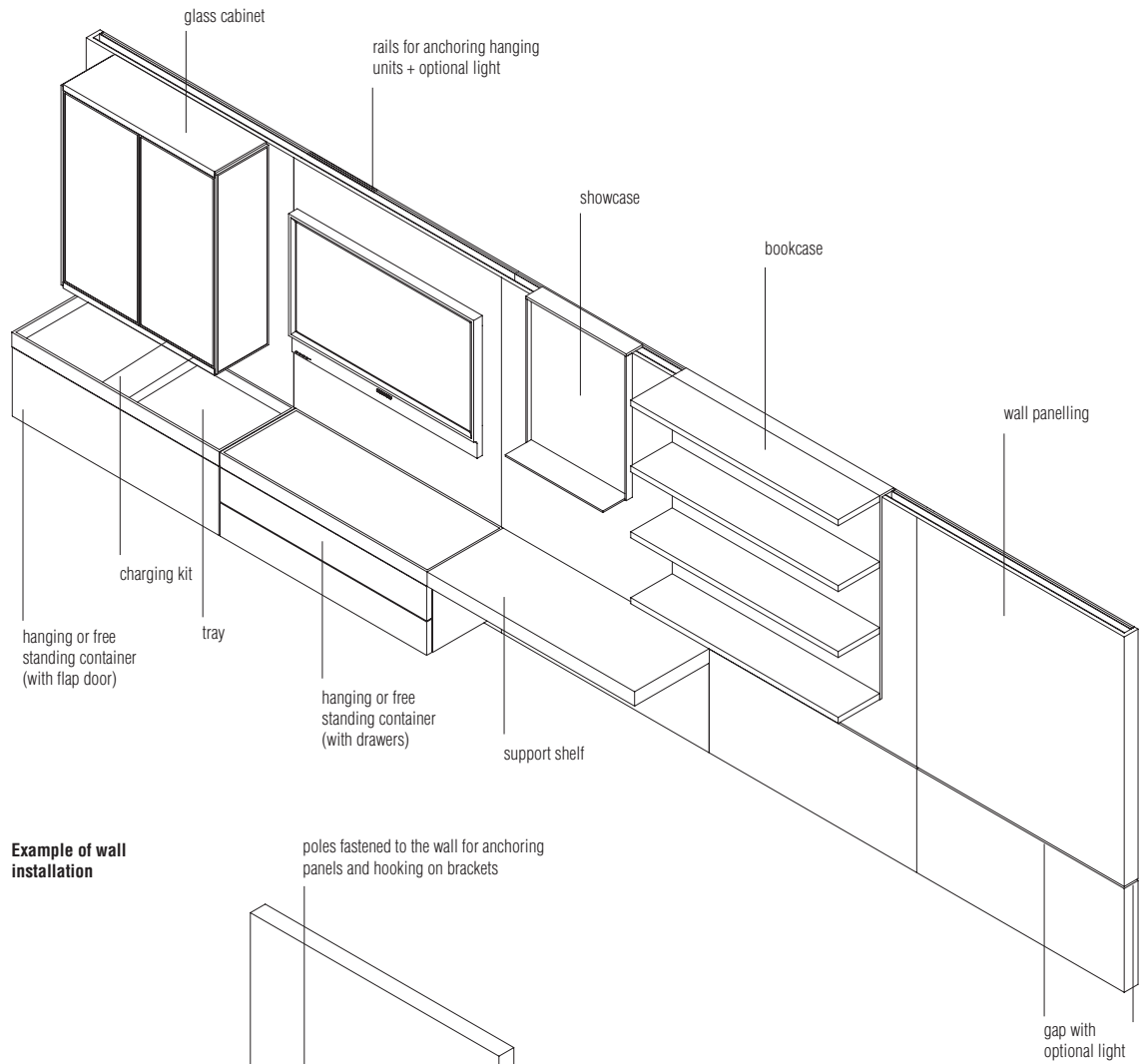

Example of wall installation

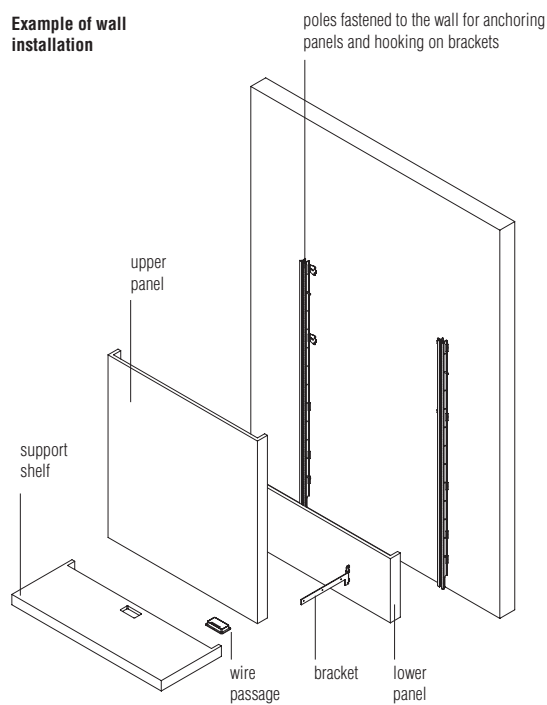

MODULARITY

Modularity of individual panelling

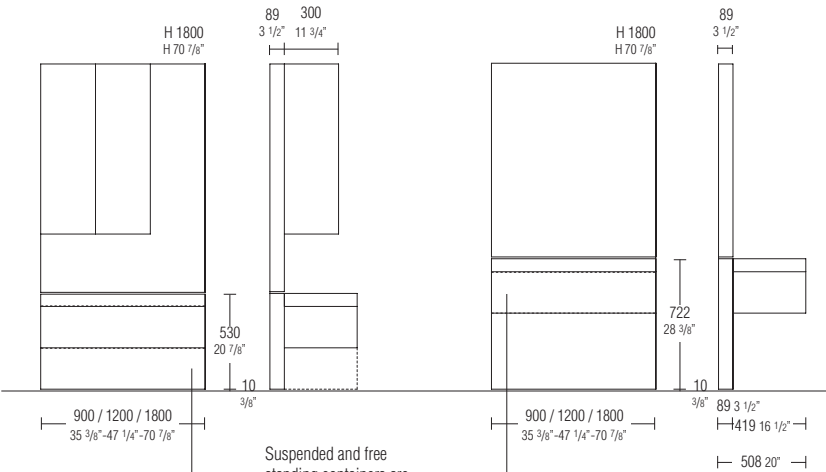

Modularity of modular panelling

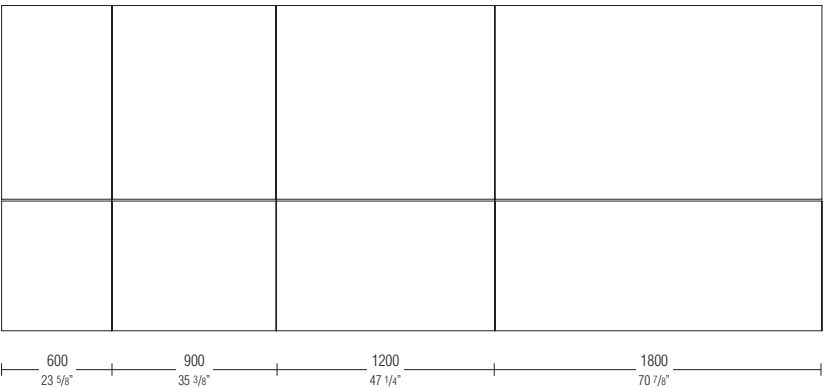
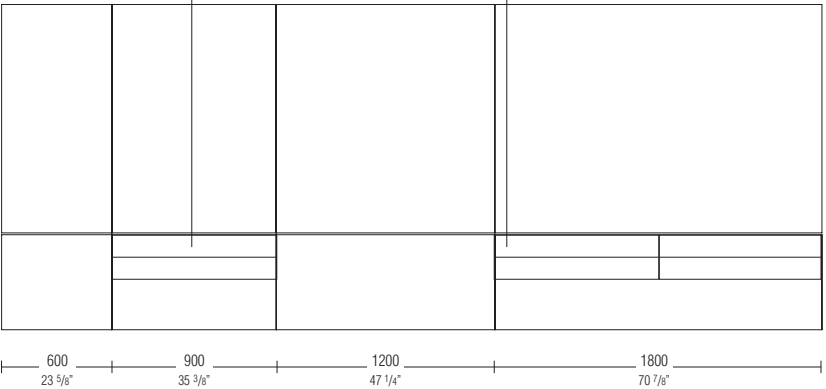

EXAMPLE OF WIRE PASSAGE

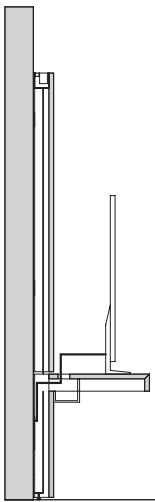
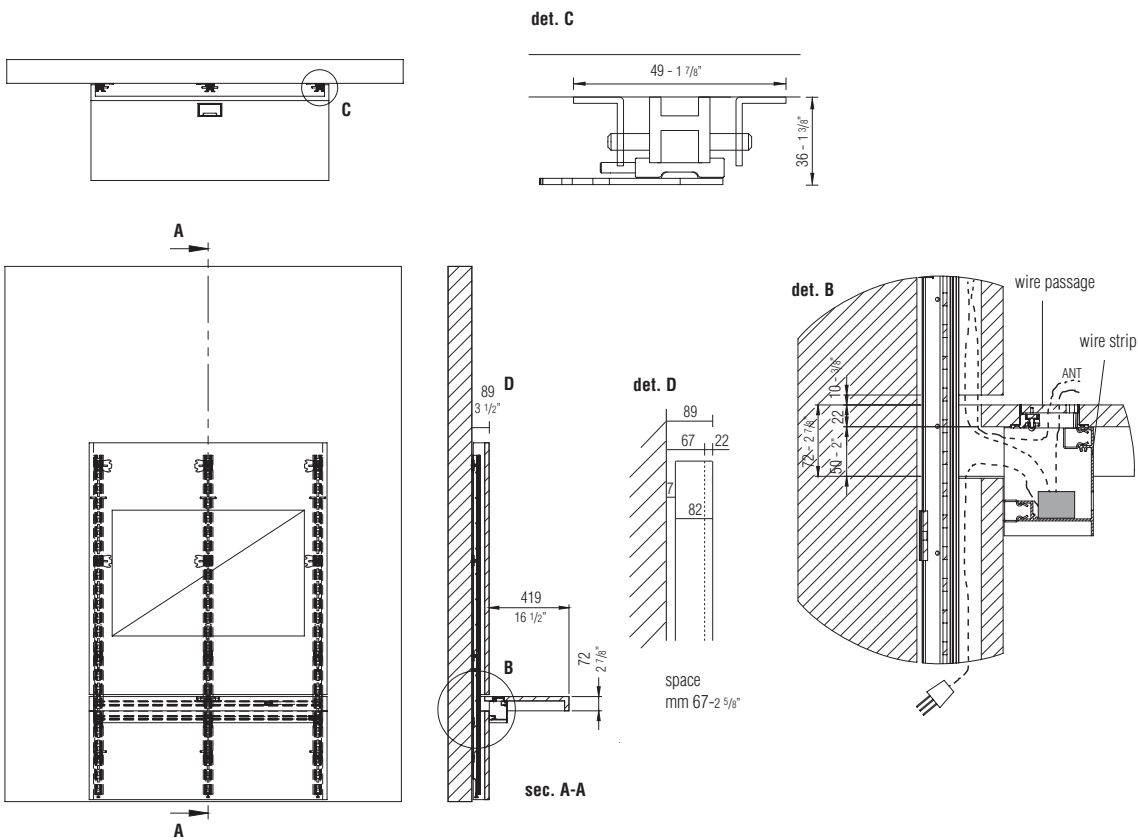

Solution 1
TV standing on support shelf

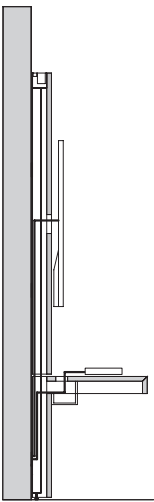

Solution 2
TV hanging from panelling
and decoder standing on
support shelf

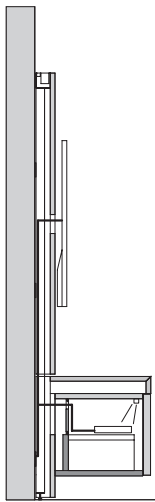

Solution 3
TV hanging from panelling
and decoder housed inside
the container with flap door -
signal transmitted by IR

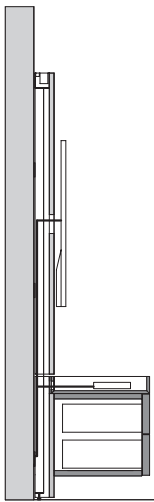

Solution 4
TV hanging from panelling,
decoder, console or PC
standing inside the tray

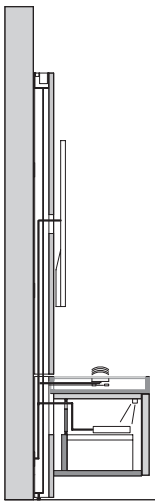

Solution 5
TV hanging from panelling
and decoder housed inside
the container with flap door -
signal transmitted by IR and
tray with induction and USB
charging box

DIMENSIONS

Individual panelling D 82 (89 from the wall)
H1 from the ground 540 / 732
Total H from the ground 1800

The panels can be reduced in width considering a surcharge (per module).
Consider a space of 15 mm in width to mount the panels.

All panelling is equipped to receive hanging elements in the upper part

panelling

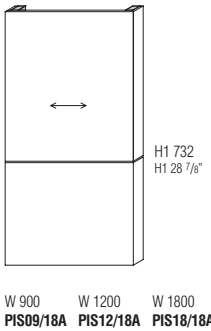
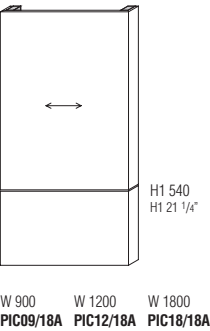

panelling for support shelf

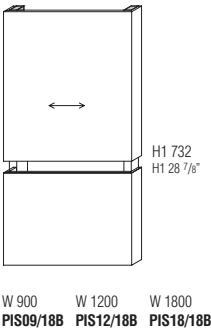
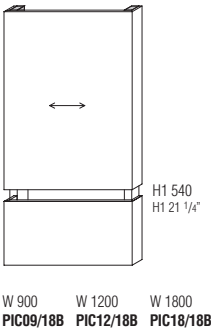

All panelling is equipped to receive hanging elements in the upper part

panelling for hanging container and free-standing container with tray or support shelf

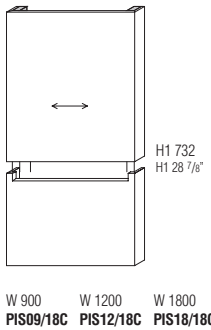
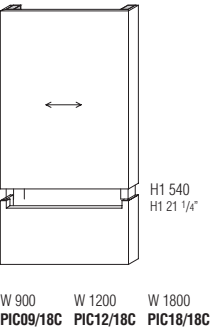

work for TV cable passage
(to be requested on the order form)

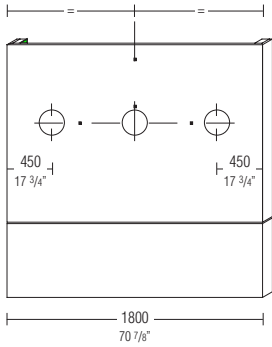
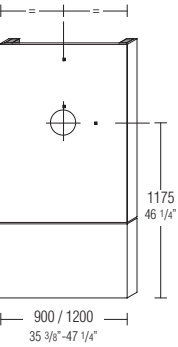

DIMENSIONS

Modular panelling D 82 (89 from the wall)
H1 from the ground 540
Total H from the ground 1800

The panels can be reduced in width considering a surcharge (per module).
Mirror-finished panels cannot be fitted with wire passages and TV sets cannot be fitted to them.
Consider a space of 15 mm in width to mount the panels.

All panelling is equipped to receive hanging elements in the upper part

left-sx panelling

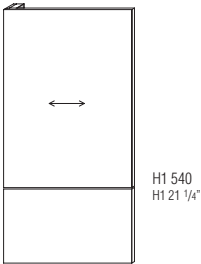

W 600 W 900 W 1200 W 1800
PSC06/18A PSC09/18A PSC12/18A PSC18/18A

left-sx panelling for support shelf

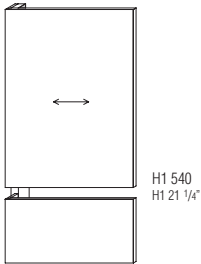

W 600 W 900 W 1200 W 1800
PSC06/18B PSC09/18B PSC12/18B PSC18/18B

left-sx panelling for hanging container and free-standing container with tray or support shelf

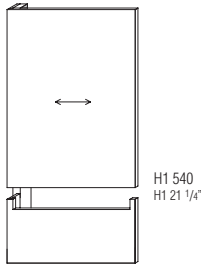

W 600 W 900 W 1200 W 1800
PSC06/18C PSC09/18C PSC12/18C PSC18/18C

All panelling is equipped to receive hanging elements in the upper part

central panelling

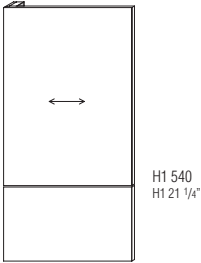

W 600 W 900 W 1200 W 1800
PCC06/18A PCC09/18A PCC12/18A PCC18/18A

central panelling for support shelf

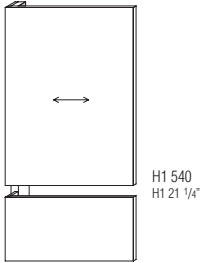

W 600 W 900 W 1200 W 1800
PCC06/18B PCC09/18B PCC12/18B PCC18/18B

central panelling for hanging container and free-standing container with tray or support shelf

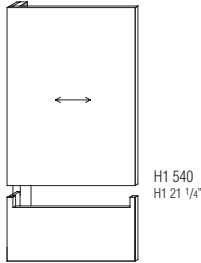

W 600 W 900 W 1200 W 1800
PCC06/18C PCC09/18C PCC12/18C PCC18/18C

All panelling is equipped to receive hanging elements in the upper part

right-dx end panelling

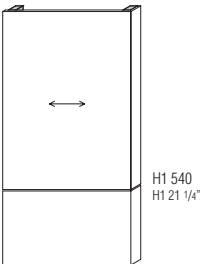

W 600 W 900 W 1200 W 1800
PDC06/18A PDC09/18A PDC12/18A PDC18/18A

right-dx end panelling for support shelf

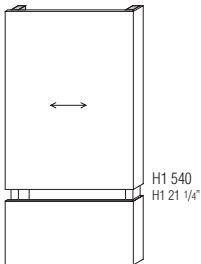

W 600 W 900 W 1200 W 1800
PDC06/18B PDC09/18B PDC12/18B PDC18/18B

right-dx end panelling for hanging container and free-standing container with tray or support shelf

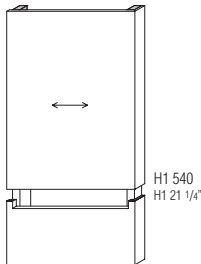

W 600 W 900 W 1200 W 1800
PDC06/18C PDC09/18C PDC12/18C PDC18/18C

DIMENSIONS

Modular panelling D 82 (89 from the wall)
H1 from the ground 732
Total H from the ground 1800

The panels can be reduced in width considering a surcharge (per module).
Mirror-finished panels cannot be fitted with wire passages and TV sets cannot be fitted to them.
Consider a space of 15 mm in width to mount the panels.

All panelling is equipped to receive hanging elements in the upper part

left-sx panelling

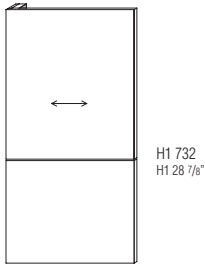

W 600 W 900 W 1200 W 1800
PSS06/18A PSS09/18A PSS12/18A PSS18/18A

left-sx panelling
for support shelf

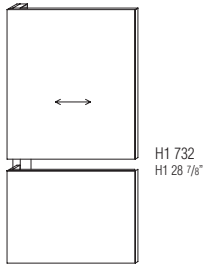

W 600 W 900 W 1200 W 1800
PSS06/18B PSS09/18B PSS12/18B PSS18/18B

left-sx panelling
for hanging container
with tray or support shelf

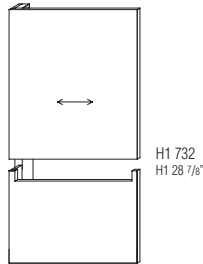

W 600 W 900 W 1200 W 1800
PSS06/18C PSS09/18C PSS12/18C PSS18/18C

All panelling is equipped to receive hanging elements in the upper part

central panelling

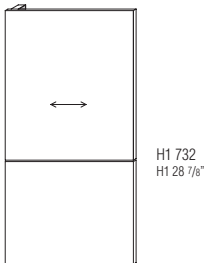

W 600 W 900 W 1200 W 1800
PCS06/18A PCS09/18A PCS12/18A PCS18/18A

central panelling
for support shelf

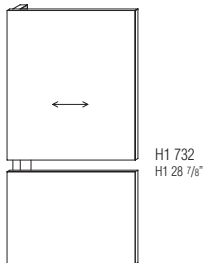

W 600 W 900 W 1200 W 1800
PCS06/18B PCS09/18B PCS12/18B PCS18/18B

central panelling
for hanging container
with tray or support shelf

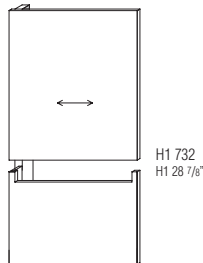

W 600 W 900 W 1200 W 1800
PCS06/18C PCS09/18C PCS12/18C PCS18/18C

All panelling is equipped to receive hanging elements in the upper part

right-dx end panelling

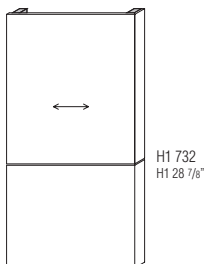

W 600 W 900 W 1200 W 1800
PDS06/18A PDS09/18A PDS12/18A PDS18/18A

right-dx end panelling
for support shelf

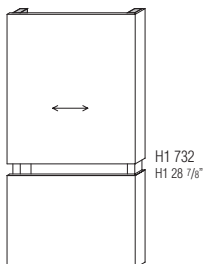

W 600 W 900 W 1200 W 1800
PDS06/18B PDS09/18B PDS12/18B PDS18/18B

right-dx end panelling
for hanging container
with tray or support shelf

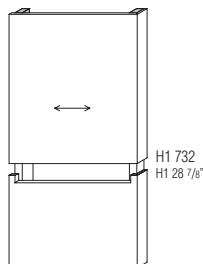

W 600 W 900 W 1200 W 1800
PDS06/18C PDS09/18C PDS12/18C PDS18/18C

DIMENSIONS

Wall panelling lighting

It is possible to light the panelling by inserting LED bars, along the entire length of the composition, in the top part, in the central part, or both.
It is possible to connect the system to a socket with switch, or to use a radio control kit (optional).

LED bars 12W per metre
max length 3000 mm
for calculations, consider the sum
of all modules
(3000° K)



per linear meter
EBIML

power supply
unit 100W

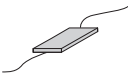

EAL1

connector
for power supply
units



EC01

radio control kit
with brightness
setting
(1 per power supply
unit)
optional



EKRR1

DALI kit
(for DOMOTICA)
n. 1 for each
power supply unit
cannot be used with
radio remote control

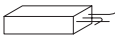

EKDA1

Example of lit wall

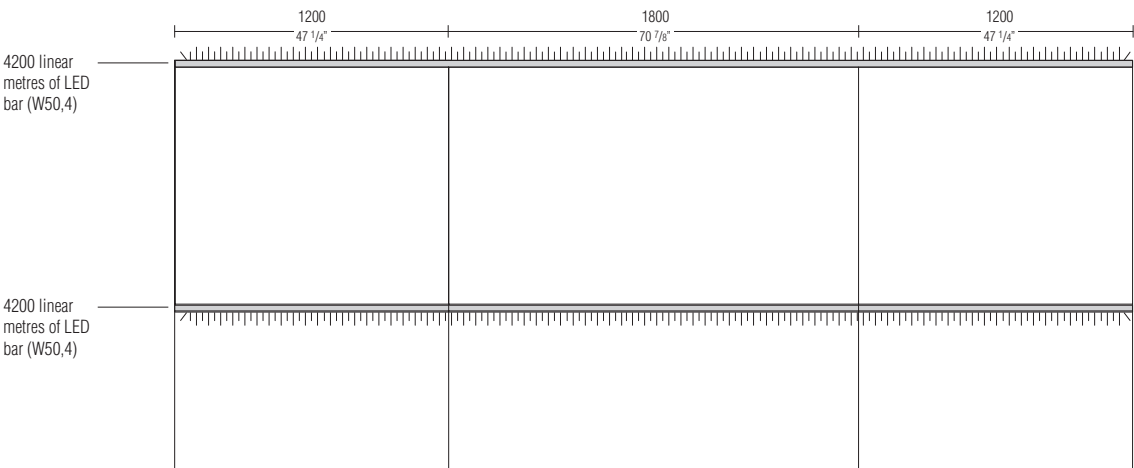

n° 2 power supply units **EAL1**
n° 1 connector **EC01**
n° 2 radio control kit **EKRR1**

DIMENSIONS

Support shelf
D 419 H 72

Supporting shelves can be reduced in width considering a surcharge each.

The support shelf is always equipped with the side brackets, while the central brackets must be added according to the modularity of the composition.

support shelf

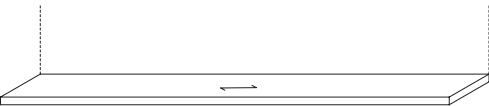

W 600	W 900	W 1200	W 1500	W 1800	W 2100	W 2400	W 2700	W 3000
MAP4/06	MAP4/09	MAP4/12	MAP4/15	MAP4/18	MAP4/21	MAP4/24	MAP4/27	MAP4/30

detachable track
underneath the
support shelf

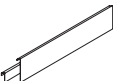

W 900	W 1200	W 1800
MCS09	MCS12	MCS18

central bracket
for support shelf



ST4

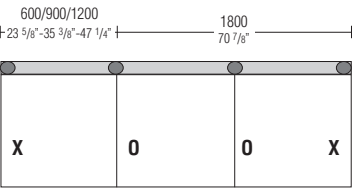

X = included in the price

O = to be added

wire passage
for support shelf
W 112 D 57



EPA3

Positioning wire passage on the support shelf

The cable gland on the supporting shelf can be positioned in relation to the modules as shown in the specified drawings

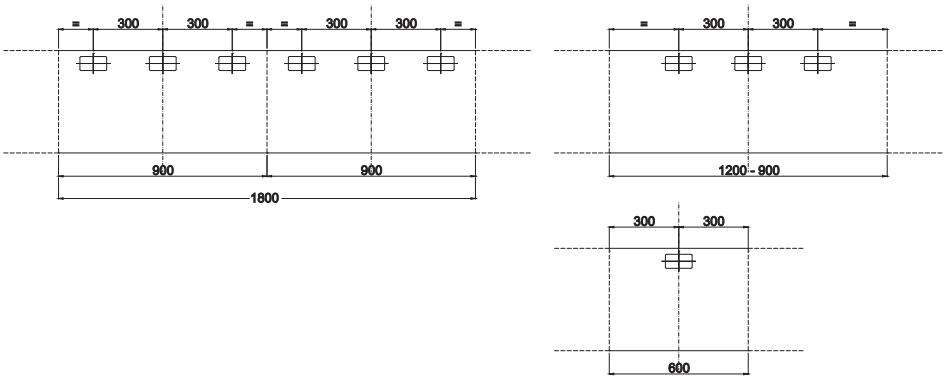

DIMENSIONS

Tray
D 419 H 72

Reductions
No reductions possible

Always to be used resting
on suspended or
free-standing containers

tray
W 600

W 900

W 1200

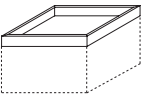

VA4/06

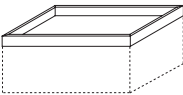

VA4/09

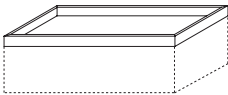

VA4/12

finishes:
ivory
dark brown
grey
mink

bottoms in Eco Skin
for trays W 600

for trays W 900

for trays W 1200



VE4/06



VE4/09



VE4/12

Including the cost
of adding the wire passage
to the tray

charging module
W 150 D 407 H 56
a) Qinside wireless recharge
b) 2 USB recharge plugs

wire passage
on the tray
W 112 D 57

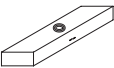

EMR1



EPA5

tray wire passage position and
charge module position

W 600

W 900

W 1200

central

central

central

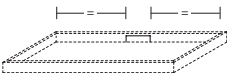
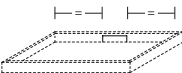
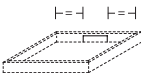

right/left

right/left

right/left

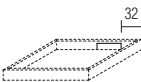

right version

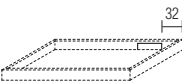

right version



right version

DIMENSIONS

Hanging container
D 419 H 347

Reductions
No reductions possible

Containers with flap door can be equipped with a wire passage, which must be indicated in the order phase.
The inside is clear of the "T" shelf (optional).

Always to be used under the support shelf or with top tray

Including fastening brackets

W 600
with pressure-opening flap door

W 900

W 1200

W 1800 (W 900 + W 900)

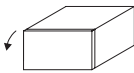

matt lacquer structure wood structure
CQSR06/34

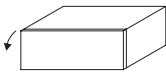

matt lacquer structure wood structure
CQSR09/34



matt lacquer structure wood structure
CQSR12/34

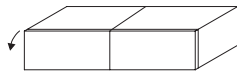

matt lacquer structure wood structure
CQSR18/34

Always to be used under the support shelf or with top tray

Including fastening brackets

W 600
with drawers

usable space
W 513 D 326 H 83

W 900

usable space
W 813 D 326 H 83

W 1200

usable space
W 1113 D 326 H 83

W 1800 (W 900 + W 900)

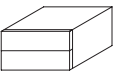

matt lacquer structure wood structure
CQSC06/34

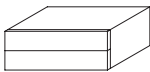

matt lacquer structure wood structure
CQSC09/34

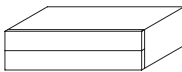

matt lacquer structure wood structure
CQSC12/34



matt lacquer structure wood structure
CQSC18/34

additional "T" shelf
H 151
for flap door containers



W 600 RQT06 W 900 RQT09/15 W 1200 RQT12/15

TV signal transmitting/receiving system with LED light for containers with flap door (transmission frequency from 30 to 38 Khz)

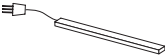

ETV1

DIMENSIONS

Free-standing container
D 419 H 445

Always to be used under the support shelf or with top tray.
Containers with flap door can be equipped with a wire passage, which must be indicated in the order phase. The inside is clear of the "T" shelf (optional).

Reductions
No reductions possible

Always to be used under the support shelf or with top tray

W 600
with pressure-opening
flap door

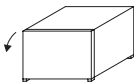

matt lacquer structure wood structure
CQTR06/44

W 900

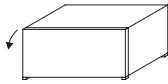

matt lacquer structure wood structure
CQTR09/44

W 1200

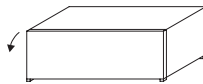

matt lacquer structure wood structure
CQTR12/44

W 1800 (W 900 + W 900)

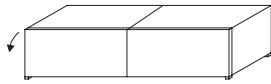

matt lacquer structure wood structure
CQTR18/44

Always to be used under the support shelf or with top tray

W 600
with drawers

usable space
W 513 D 326 H 83/196

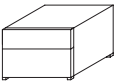

matt lacquer structure wood structure
CQTC06/44

W 900

usable space
W 813 D 326 H 83/196

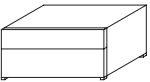

matt lacquer structure wood structure
CQTC09/44

W 1200

usable space
W 1113 D 326 H 83/196

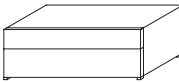

matt lacquer structure wood structure
CQTC12/44

W 1800 (W 900 + W 900)

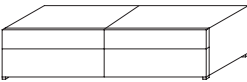

matt lacquer structure wood structure
CQTC18/44

additional "T" shelf
H 248
for flap door containers



W 600 W 900 W 1200
RQT06 RQT09/25 RQT12/25

TV signal transmitting/receiving
system with LED light for
containers with flap door
(transmission frequency
from 30 to 38 KHz)

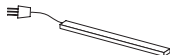

ETV1

DIMENSIONS

Bookcase
D 252

- To create bookcases with LED lighting consider: LED increase, power supply unit and, if there is no pre-fitted element for the switched socket, also the remote control kit.

- The bookcase lighting system is separate from the one for the panelling, but it can be integrated with the one for the glass cabinets if they do not exceed 100W.
- The lighting system includes LEDs on all shelves in the bookcase, excepted the lower shelf.
- 3000° K LED light

Reductions

No reductions possible

H 690
3 shelves

W 450
10 watt

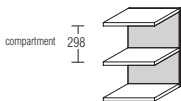

matt lacquer
back
LDS04/07

W 600
14 watt

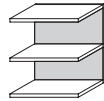

matt lacquer
back
LDS06/07

W 900
20 watt

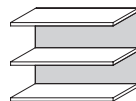

matt lacquer
back
LDS09/07

W 1200
28 watt

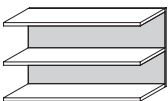

matt lacquer
back
LDS12/07

H 1020
4 shelves

W 450
15 watt

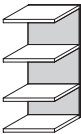

matt lacquer
back
LDS04/10

W 600
21 watt

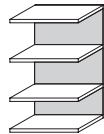

matt lacquer
back
LDS06/10

W 900
30 watt

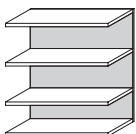

matt lacquer
back
LDS09/10

W 1200
42 watt

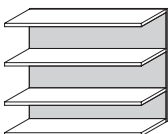

matt lacquer
back
LDS12/10

Bookcase accessories

partition
W 300 H 298 D 238



DVL03

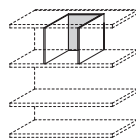

finishes:
ivory
dark brown
dove grey
black
natural
mud green

power supply
unit 100W

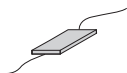

EAL1

radio control kit
with brightness setting
(1 per power supply unit)
optional



EKRR1

connector
for power supply
units



EC01

DIMENSIONS

Showcase
D 150

Reductions
No reductions possible

Max capacity of the shelf 5 kg
evenly distributed

H 580
W 580



EDS05/05

H 686
W 580

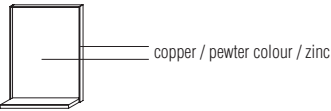

EDS05/06

Showcase
with mirror

H 1016
W 580

In the order, specify the finish
of the perimeter profile and
shelf (pewter colour /
copper / zinc lacquer)

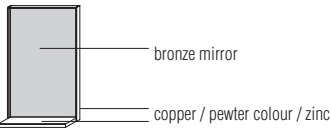

EDS05/10

DIMENSIONS

Glass cabinet D 300
Glass side

- Pewter colour / copper / zinc painted profile.
- Transparent stopsol glass.
- Optional interior lighting.
- To create glass cabinets with LED lighting consider: LED increase, power supply unit and, if there is no pre-fitted element for the switched socket, also the remote control kit.

- The glass cabinet lighting system is separate from the one for the panelling, but it can be integrated with the one for the bookcases if they do not exceed 100W.
- Provision is made to position the LED bar in the lid.
- 3000° K LED light.

Reductions
No reductions possible

H 1020
W 600
7 watt
opening only right

inside layout

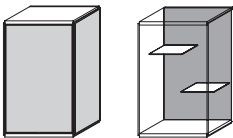

pewter colour/copper/zinc
lacquered back
VTSV06/10

W 900
10 watt
inside layout

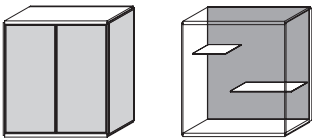

pewter colour/copper/zinc
lacquered back
VTSV09/10

power supply
unit 100W

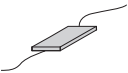

EAL1

radio control kit
with brightness setting
(1 per power supply unit)
optional



EKRR1

connector
for power supply
units



EC01

DIMENSIONS

Glass cabinet D 300
Glass side

- Pewter colour / copper / zinc painted profile.
- Transparent stopsol glass.
- It is not possible to insert LED lighting.

Reductions
No reductions possible

with n° 2
internal shelves

H 1020
W 600

opening only right

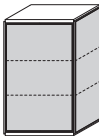

pewter colour/copper/zinc
lacquered back
VTSW06/10

W 900

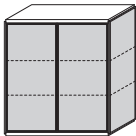

pewter colour/copper/zinc
lacquered back
VTSW09/10

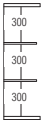

Glass cabinet D 300
Pewter colour / copper matt lacquered side

- Door pewter colour / copper / zinc painted profile.
- Transparent stopsol glass.
- It is not possible to insert LED lighting.

Reductions
No reductions possible

with n° 2
internal shelves

H 1020
W 600

opening only right

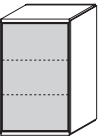

pewter colour/copper/zinc
lacquered back

W 900

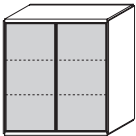

pewter colour/copper/zinc
lacquered back

